

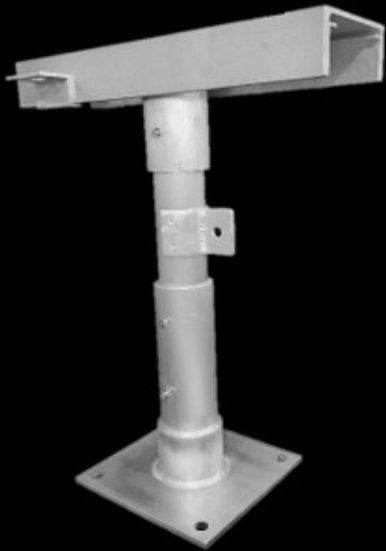

Quickstands: Revolutionizing Industrial Support Systems



A Multi-Configurational modular support system for piping and overhead installations

Our patent-pending kits are designed to be:

- Easily adjustable
- Prefabricated
- Available for quick delivery

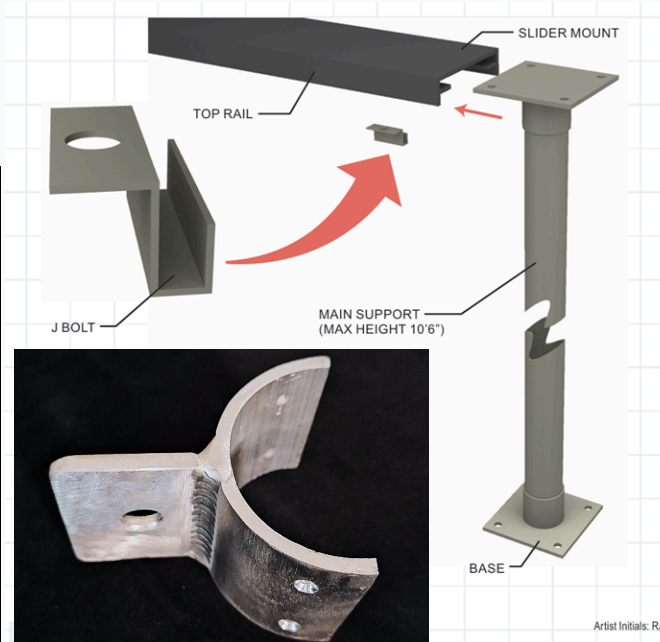

Our solutions are designed to provide hassle-free and effective support for various industries.

To learn more about how our kits can elevate your projects or to request a quote, please contact us today!

Contact Us Today



www.ElevatedSupportSolutions.com



Gary@ElevatedSupportSolutions.com

Elevated Support Solutions, LLC is at the forefront of providing innovative pipestand solutions.

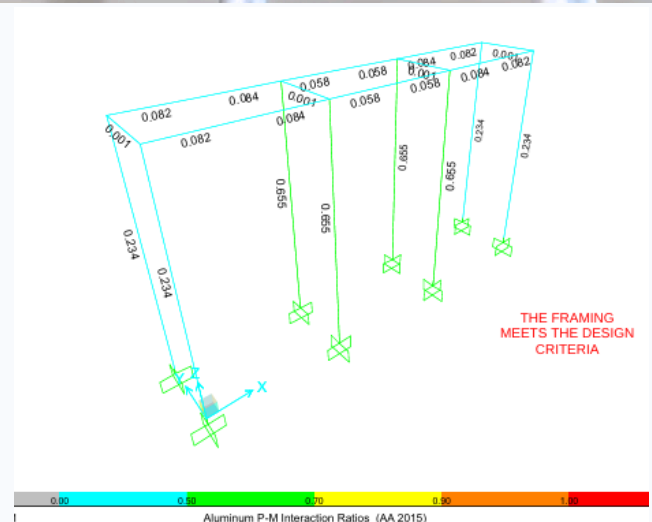

Our Products

Browse our range of innovative and prefabricated modular support solutions.

Customize the perfect kit for your needs today!



Heavy Duty Pipestand

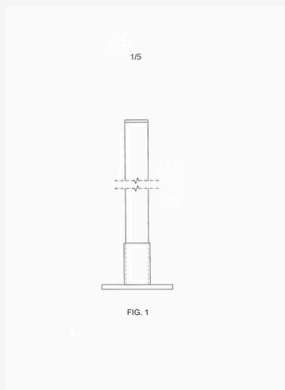

Duct Stand

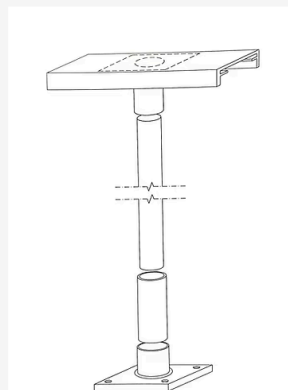

Single Leg Pipe Stand

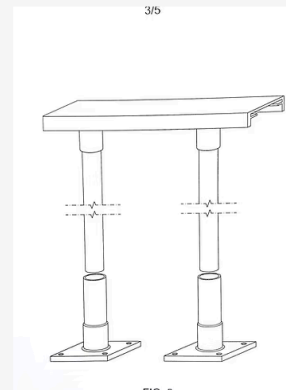

Double Leg Pipe Stand



Tower Stand

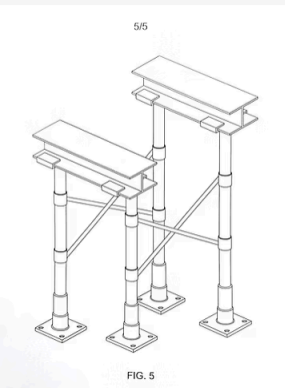

I Beam Tower Stand With Cross Bracing

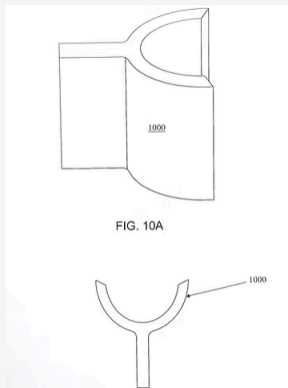

Cross Brace Adaptor Kit



U Bolt Tie Downs

Why Choose Us?

- Our multi-configurational modular support can be customized to fit your specific requirements, providing reliable stability and flexibility for every installation
- Efficient systems are delivered swiftly, ensuring you get the support you need when you need it most
- Aluminum construction eliminates the need for galvanizing reducing environmental impact
- Elimination of the requirement for on-site welding, manual fabrication, and excessive handling decreases work related injuries
- Cutting-edge Vectis equipment provides a consistent, reliable product with uniform Cobot welds.
- Tie-downs, cross-bracing, and modular anchoring components help meet regional building codes

Patent Pending – U.S. Application No. 19/174,074